

Cod. MT	Mandrino Spindle Spindel	I	RPM	Coppia Max Max Torque Max Drehmoment	Lubr.interna Coolant through Innenkuehlung	Lubr. esterna Ext. coolant Aussenkuehlung	A	CHIAVI NON INCLUDE Keys not included Schluessel nicht einbegriffen		
DW01992140	ERA40	2:1	3000	160Nm	-	X	7	CHUB36	OKU0430007	CHTAER40ZC
DW01994240	ERA40	2:1	3000	160Nm	P=70bar	X	18	CHUB36	OKU0430007	CHTAER40ZC

- Chiave inclusa
- Key included
- Schluessel inbegriffen

VICTOR  
 MOD: VTURN-40/45YCM - VTURN-S36CM - VTURN-V760CM (BMT75)

MODULO MOTORIZZATO RADIALE RIDOTTO I=2:1 DISASSATO IN Z 100mm  
 Radial geared-down I=2:1 driven tool re-directed in Z by 100mm  
 Radial angetriebenes Werkzeug untersetzt I=2:1 achsversetzt in Z um 100mm

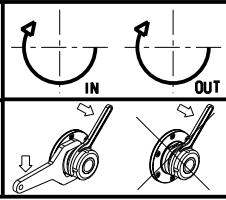

**M.T. srl**  
 Via Casino Albini 480  
 Tel. 0541/956034-957884  
 Fax 0541/956341  
 47842 S. GIOVANNI IN M. (RN)  
 e-mail: mtma@mtmarchetti.com  
 http://www.mtmarchetti.com



VCT030-3-20

Subject to change without notice.