

- Chiave inclusa
- Key included
- Schluessel inbegriffen

Cod. MT	Mandrino Spindle Spindel	I	RPM	Coppia Max Max Torque Max Drehmoment	Lubrificazione est. Ext. coolant Aussenkuehlung	Lubrificazione int. Coolant through Innenkuehlung	A	A1	D	L	CHIAVI NON INCLUSE Keys not included Schluessel nicht einbegriffen		
OKU0790132	ERA32	1:1	6000	70Nm	X	-	55.5	-	-	-	CHUB30	CHTAER32ZC	OKU0650004
OKU1860432	ERA32	1:1	6000	70Nm	X	P=70bar	69	-	-	-	CHUB30	CHTAER32ZC	OKU0650004
OKU0791617	Ø16x17	1:1	6000	70Nm	X	-	-	50.5	16	17	-	CH_VTCROCE_M08	OKU0650004
OKU0791919	Ø3/4"x3/4"	1:1	6000	70Nm	X	-	-	50.5	3/4"	3/4"	-	CH_VTCROCE_M08	OKU0650004
OKU0792219	Ø22x19	1:1	6000	70Nm	X	-	-	52	22	19	-	CH_VTCROCE_M10	OKU0650004
OKU0792721	Ø27x21	1:1	6000	70Nm	X	-	-	54	27	21	-	CH_VTCROCE_M12	OKU0650004
OKU0792519	Ø1"x19	1:1	6000	70Nm	X	-	-	54	1"	19	-	CH_VTCROCE_M12	OKU0650004

OKUMA
 MOD: LB2000-2500-3000EX(I) M/MY/MW/MYW - LB2000-2500-3000EX(II) M/MY/MW/MYW - LU3000EX M/MY/MW
 MULTUS U3000/4000/5000 2SW - GENOS L300MW/MYW - GENOS L3000e M/MY

MODULO MOTORIZZATO RADIALE
 Radial driven tool
 Radial angetriebenes Werkzeug

Subject to change without notice.

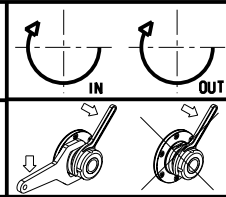

M.T. srl
 Via Casino Albini 480
 Tel. 0541/956034-957884
 Fax 0541/956341
 47842 S. GIOVANNI IN M. (RN)
 e-mail: mtma@mtmarchetti.com
 http://www.mtmarchetti.com

