

| Cod. MT | Mandrino Spindle Spindel | i | RPM MAX | Coppia Max Max Torque Max Drehmoment | Reversibile lato mandrino/contromandrino Reversible sub/main spindle side Umkehrbare Spindel-seite/ Gegenspindel-seite | Lubrificazione int. Coolant through Innenkühlung | Lubrificazione est. Ext. coolant Aussenkühlung | CHIAVI NON INCLUSE Keys not included Schlüssel nicht einbegriffen | |
|-------------|--------------------------------|-----|------------|--|---|--|--|---|--------|
| | | | | | | | | CHSTER25 | CHUB36 |
| DW 00570125 | ER25 | 1:3 | 12000 | 60Nm | X | - | X | CHSTER25 | CHUB36 |
| DW 00570225 | ER25 | 1:3 | 12000 | 60Nm | X | P=70bar | X | CHSTER25 | CHUB36 |

DN SOLUTIONS (DOOSAN) BMT 75

MOD: PUMA 400 - PUMA 480M/LM/XLM - PUMA 4100M - PUMA 5100M/Y - V550M - V8300M

MODULO MOTORIZZATO ASSIALE MOLTIPLICATO I=1:3

Axial geared-up I=1:3 driven tool

Axial angetriebenes Werkzeug uebersetzt I=1:3

Subject to change without notice.

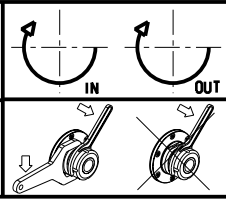

M.T. srl
 Via Casino Albini 480
 Tel. 0541/956034-957884
 Fax 0541/956341
 47842 S. GIOVANNI IN M. (RN)
 e-mail: mtma@mtmarchetti.com
 http://www.mtmarchetti.com



DW 0205-4-10