

- Chiave inclusa
- Key included
- Schlüssel inbegriffen

Cod. MT	Mandrino Spindle Spindel	I	RPM	Coppia Max Max Torque Max Drehmoment	Lubrificazione int. Coolant through Innenkuehlung	Lubrificazione est. Ext. coolant Ausseenkuehlung	A	A1	A2	D	L	CHIAVI NON INCLUDE Keys not included Schlüssel nicht einbegriffen	
BGL1020316	ER16	1:1	6000	25Nm	-	X	66	-	-	-	-	CHUB36	CHMNER16
BGL1020416	ER16	1:1	6000	25Nm	P=30bar	X	66	-	-	-	-	CHUB36	CHMNER16
BGL1020320	ER20	1:1	6000	25Nm	-	X	58.2	-	-	-	-	CHUB36	CHSTER20
BGL1020420	ER20	1:1	6000	25Nm	P=30bar	X	65.7	-	-	-	-	CHUB36	CHSTER20
BGL1020325	ER25	1:1	6000	25Nm	-	X	59.2	-	-	-	-	CHUB36	CHSTER25
BGL1020120	ERA20	1:1	6000	25Nm	-	X	42.2	-	-	-	-	CHUB36	CHUB22
BGL1020220	ERA20	1:1	6000	25Nm	P=30bar	X	49.7	-	-	-	-	CHUB36	CHUB22
BGL1020512	WELDON 12	1:1	6000	25Nm	-	X	-	42.5	-	-	-	-	-
BGL1020716	Ø16x17	1:1	6000	25Nm	-	X	-	-	38.5	16	17	CHUB36	CH_VTCROCE_M08 *

BIGLIA
MOD: B436/438 - BMX 45Y2

MODULO MOTORIZZATO RADIALE
Radial driven tool
Radial angetriebenes Werkzeug

Subject to change without notice.

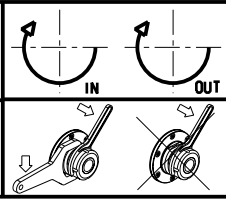

M.T. srl
Via Casino Albini 480
Tel. 0541/956034-957884
Fax 0541/956341
47842 S. GIOVANNI IN M. (RN)
e-mail: mtma@mtmarchetti.com
http://www.mtmarchetti.com



PAGINA BGL010-2-00